

# GAS LINE STRAINERS

MODEL: 5730 - ES

Revision: 0

BULLETIN  
5730

## DESCRIPTION

Elbow type **Gas Line Strainers** are designed to entrap and retain foreign matter, dirt, and metal chips that may flow in gas or air supply lines. Stainless steel baskets with 0.02" perforations will handle gases up to 750 °F.

These full flow strainers have a line pressure loss equivalent to 3 feet of straight pipe of the same diameter. The bodies are one-piece cast iron with a removal cover. Maximum line pressure rating is 50 psig.

The basket handle fits the top of the cover with a slight spring tension sealing pressure between the basket and the body.

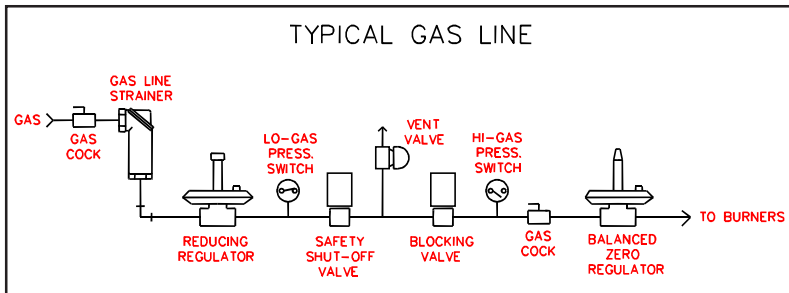

## INSTALLATION INSTRUCTIONS

1. Install strainer in gas line as indicated in typical gas line system sketch for foreign matter to be retained in basket.
2. Position strainer with minimum head clearance indicated in dimension "G" for full basket removal.
3. Use approved thread sealing compound.
4. Support pipe properly.



## FEATURES

### STOP

- Dirt
- Metal Chips
- Foreign Matter in Gas Lines

### PREVENTS

- Leakage Through
  - Regulators
  - Zero Governors Due to Dirt Under Seals
  - Valves

CAUTION: Operation of combustion equipment can be hazardous resulting in bodily injury or equipment damage. Each burner should be supervised by a combustion safeguard and only qualified personnel should install, make system adjustments and perform any required service.



**pyronics inc.**

COMBUSTION FOR INDUSTRY

17700 MILES ROAD  
CLEVELAND, OH 44128  
www.pyronics.com

Tel: 216-662-8800  
Fax: 216-663-8954  
marketing@pyronics.com

NOTICE: PYRONICS practices a policy of continuous improvement in the design of its products. It reserves the right to change the specifications at any time without prior notice.

# GAS LINE STRAINERS

BULLETIN 5730  
PAGE NO.2

## DIMENSIONS

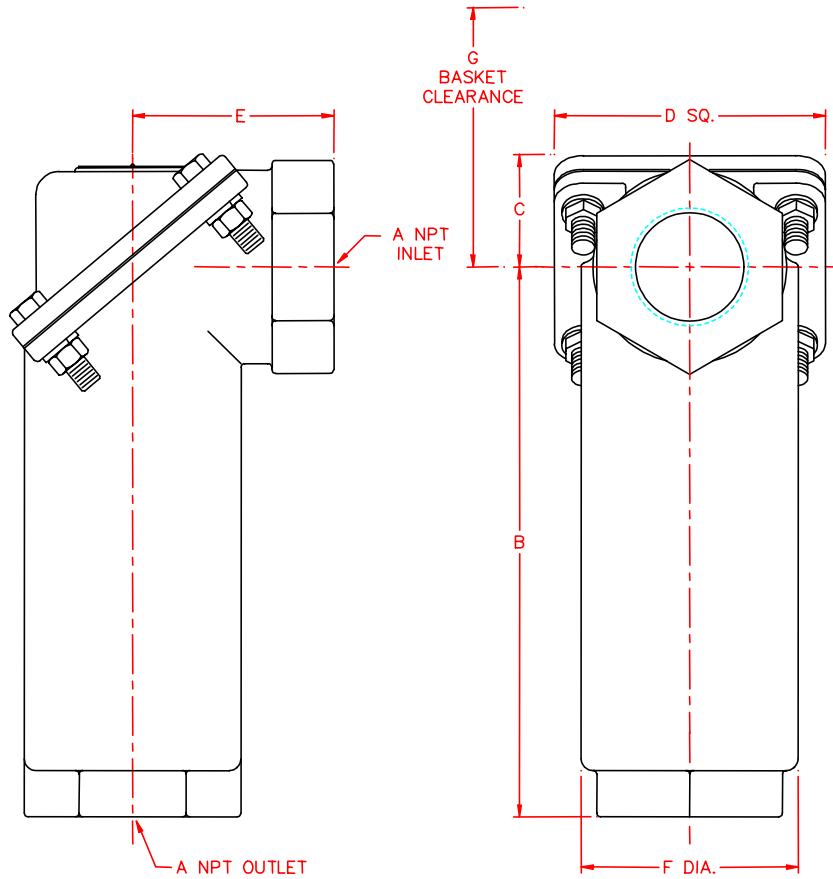

Model Number	A	B	C	D	E	F	G	Weight Lbs.
ES-12	1-1/2	8-7/8	1-7/8	4-1/2	3-1/4	3-1/2	9	14
ES-16	2	8-7/8	1-7/8	4-1/2	3-1/4	3-1/2	9	14
ES-20	2-1/2	13	2-3/4	6	4	5	13	32
ES-24	3	13	2-3/4	6	4	5	13	32

NOTE: All dimensions are in inches.

## ORDERING INFORMATION

1. Specify Model Number and Quantities
2. Shipping Instructions

The content on or accessible through CombustionDepot.com, (including, but not limited to) text, graphics and other materials, are provided by CombustionDepot.com, for informational purposes only. CombustionDepot.com does not claim ownership to any of the photos, images, or pictures of products on the site. These depictions are solely for information purposes and may not be an exact replication of the related product available for sale. All PDF and specification pages are gathered from the OEM web sites or publicly available information. CombustionDepot.com does not claim responsibility for any of the information found on these bulletins, documents, literature, specification charts, etc. and such information is subject to change without notice.